

# POSTE DE CONCRETO PCR-9-400

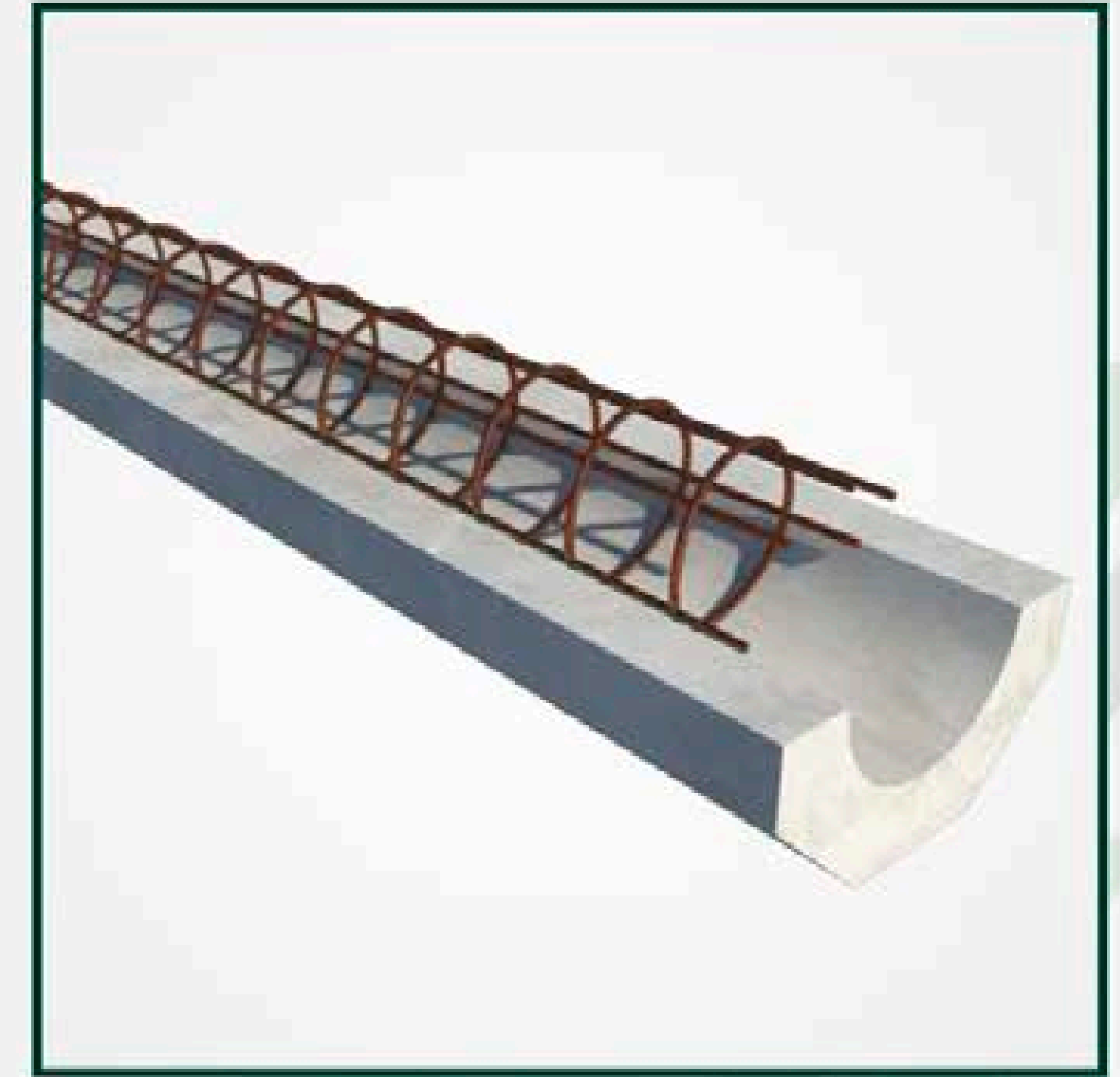
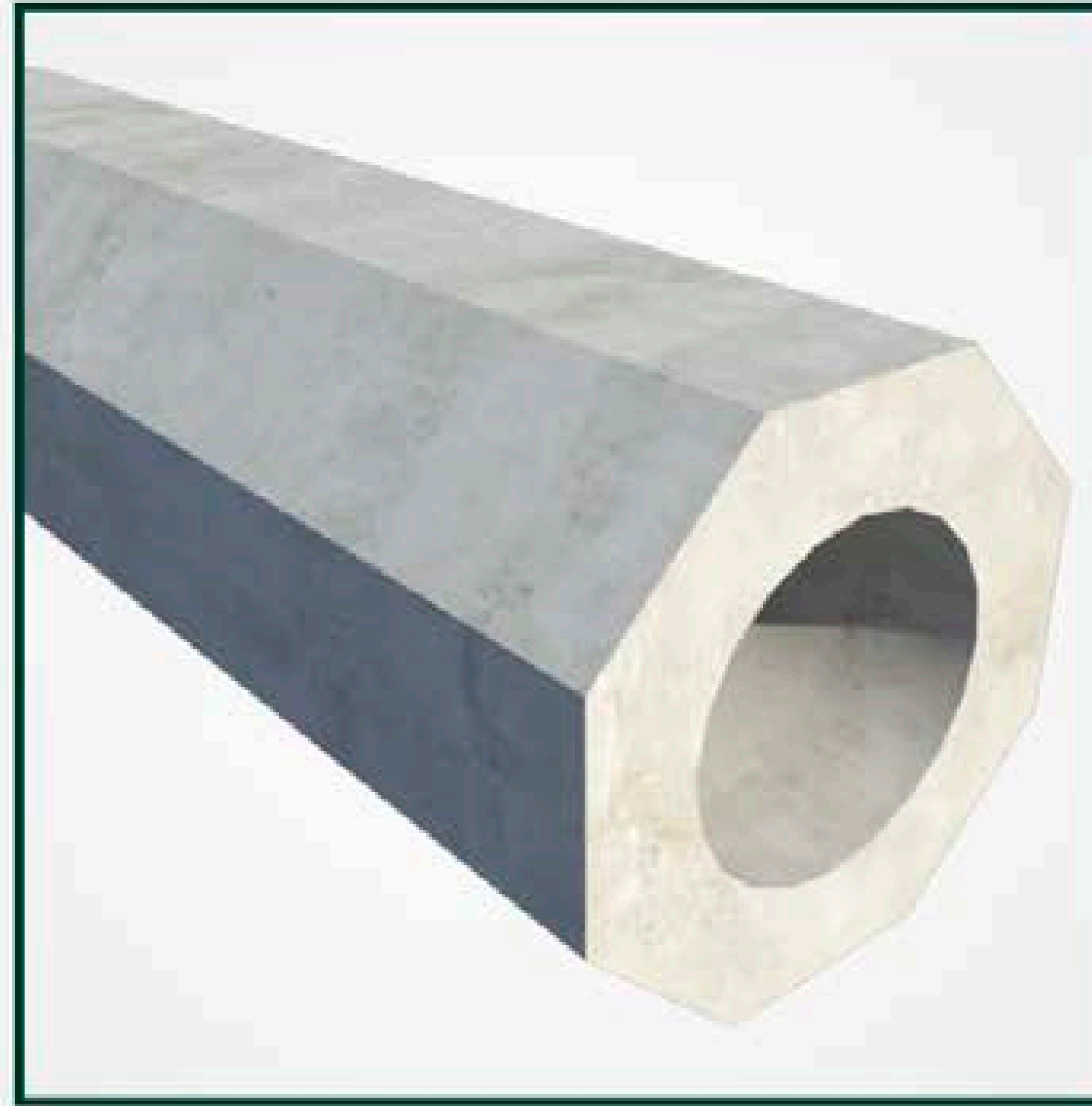

## ESPECIFICACIONES

1. Resistencia a la ruptura: 3,924 N
2. Masa aproximada: 629 kg
3. Empotramiento: 1400 mm

 **CONCRETO**

# POSTE DE CONCRETO PCR-9-400 (DIMENSIONES)

